

SANY SPCS SYSTEM INTRODUCTION FOR RAFAL GROUP & CITIC CONSTRUCTION

1. SPCS SYSTEM

Precast components in SPCS system include: precast column & beams, slab, double layer wall, etc

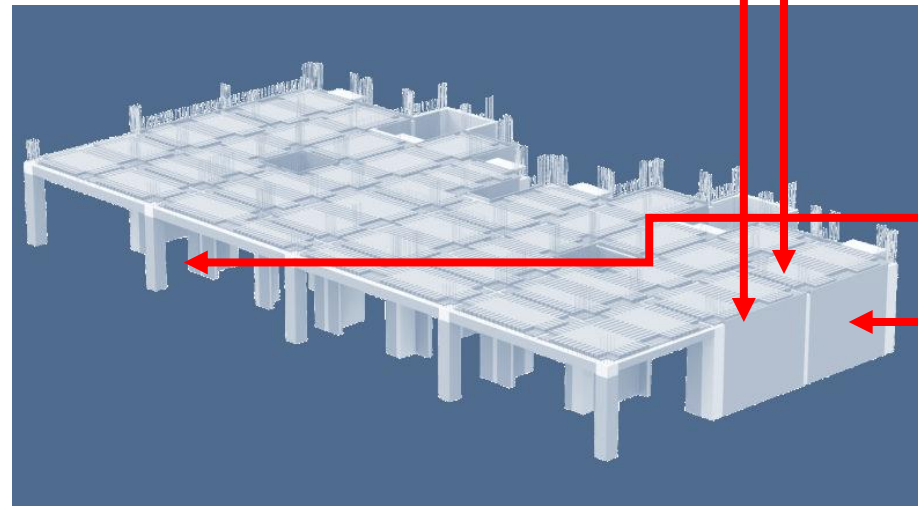
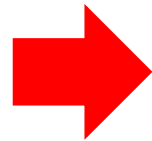

Convert conventional design into SPCS system

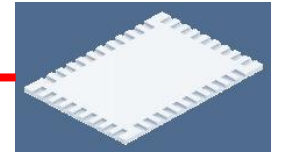

Slab

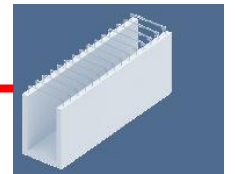

Beam

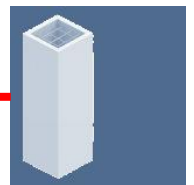

Column



Double layer wall

2. SPCS DOUBLE WALL

Reinforcement cage is identical to conventional method

Inner and outer walls replace formworks in conventional system

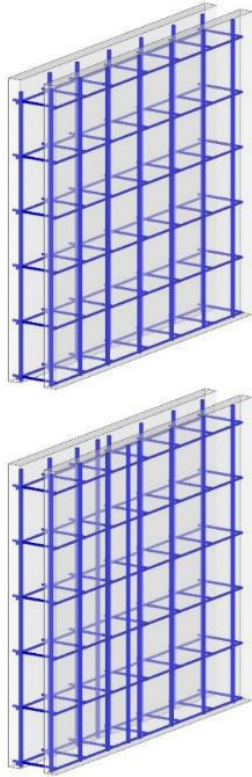

Reinforcement cage for connection is placed inside hollow core

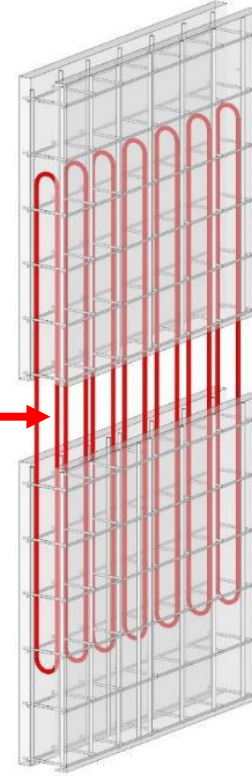

Fill in concrete inside hollow core on site to form up an entity

On site casting can prevent leakage

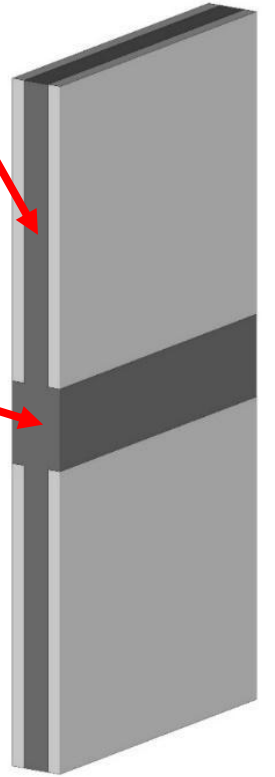

Hollow core precast wall

Prefab in factory



Steel bar bonding

Fast installation and high precision



On site casting

Structure is safe

3. SPCS DOUBLE WALL

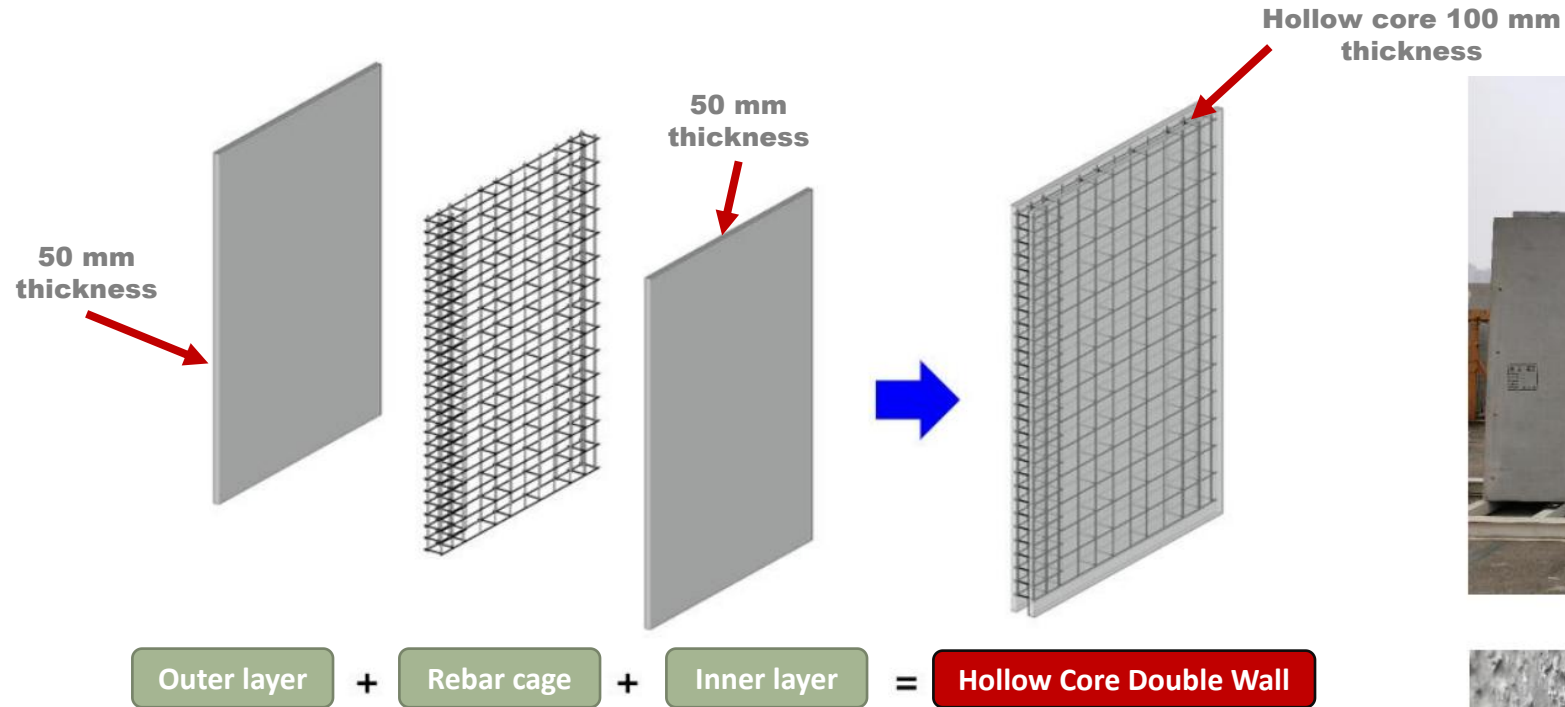

- Both outer and inner layers are prefab
- No starter bars required on all sides
- Large hollow core inside wall panel
- Connected by high-strength rebar cage
- Meet the requirement of smart production



4. SPCS INSULATION PANEL

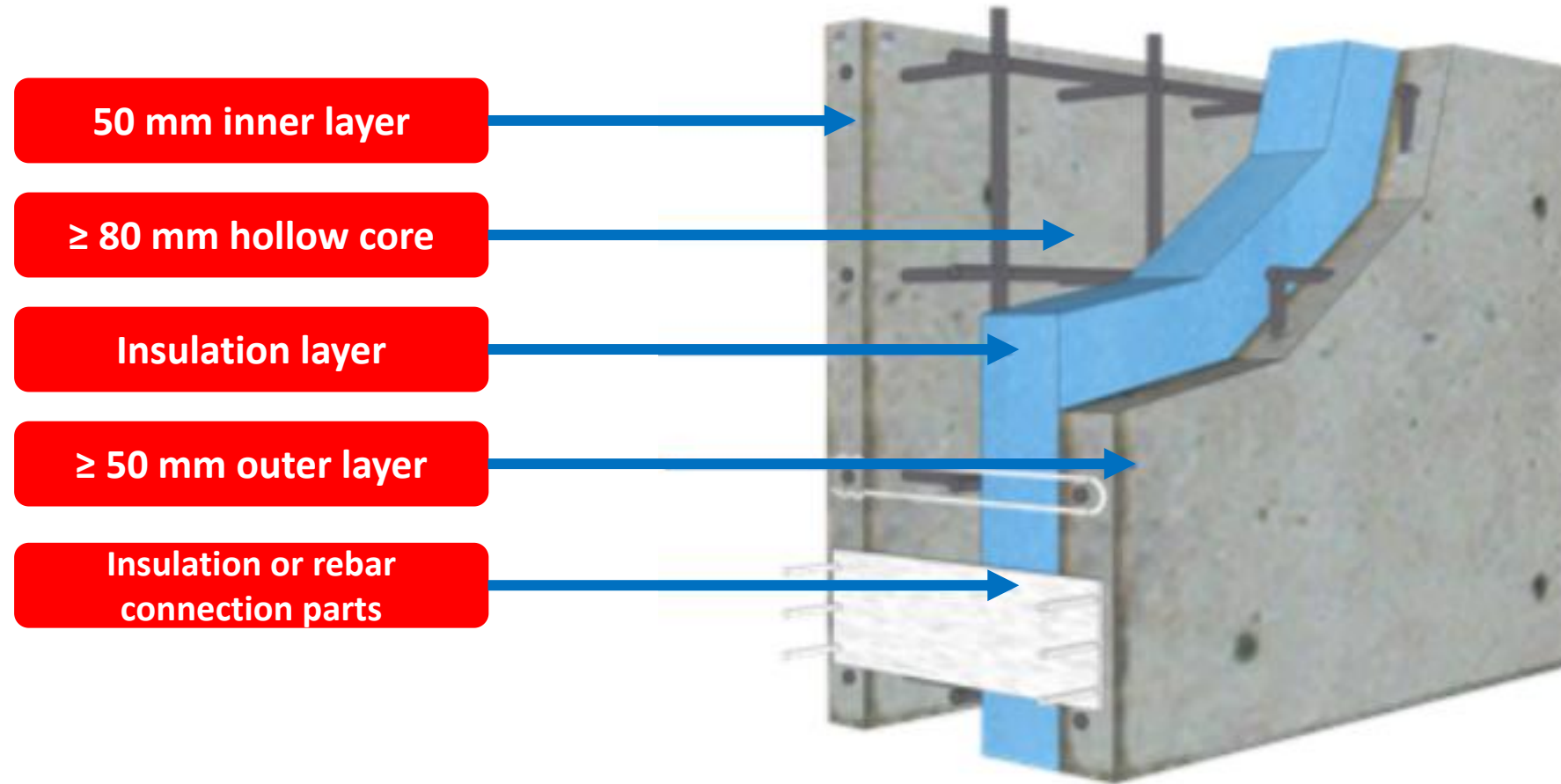

5. SPCS HOLLOW CORE COLUMN

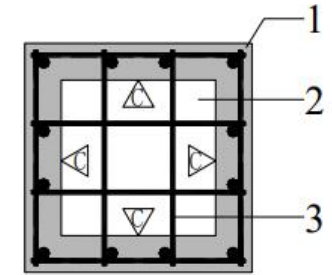
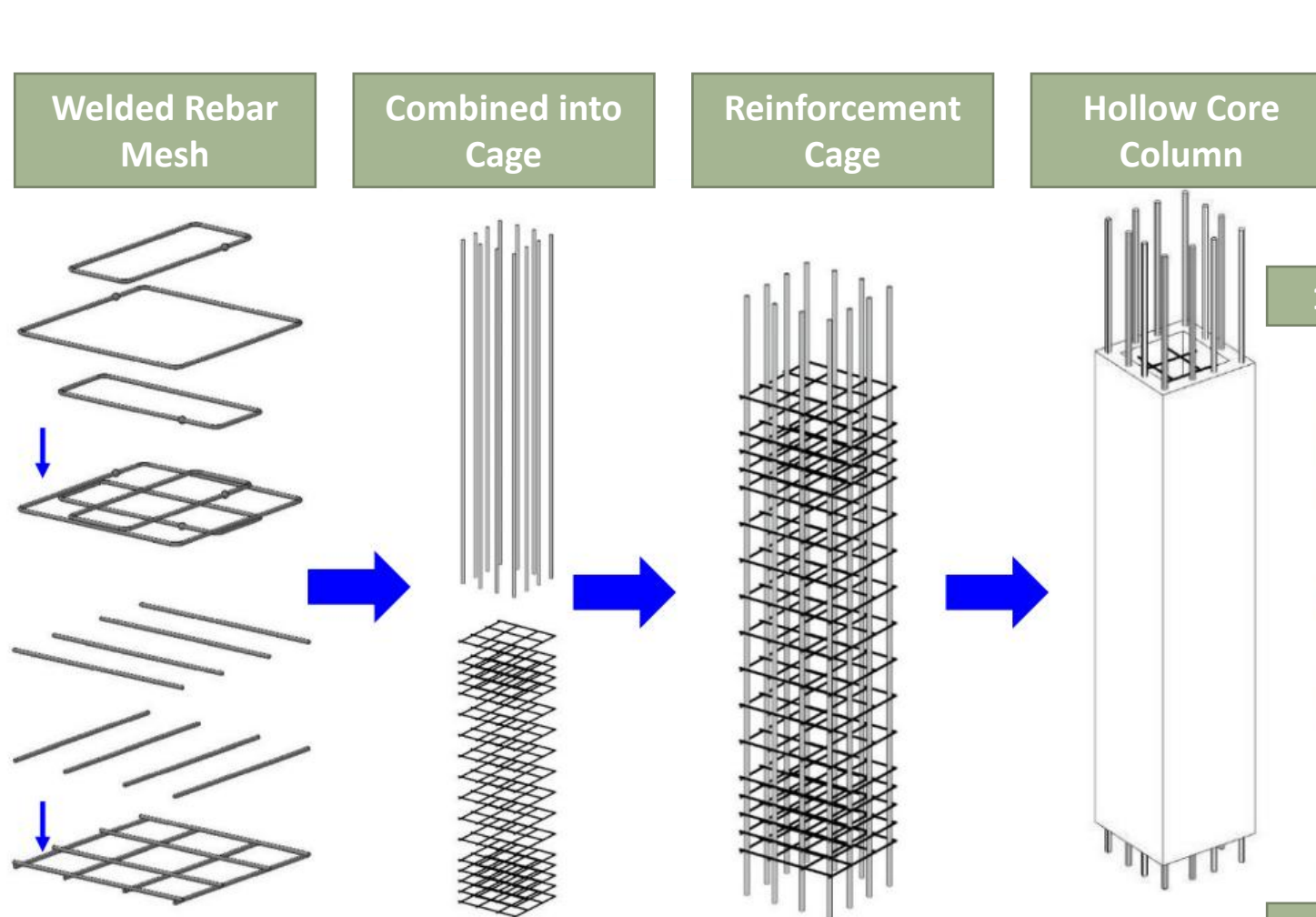

1. Precast 2. Hollow Core 3. Rebar Cage



Precast Hollow Core Column

6. SPCS CONNECTION JOINTS

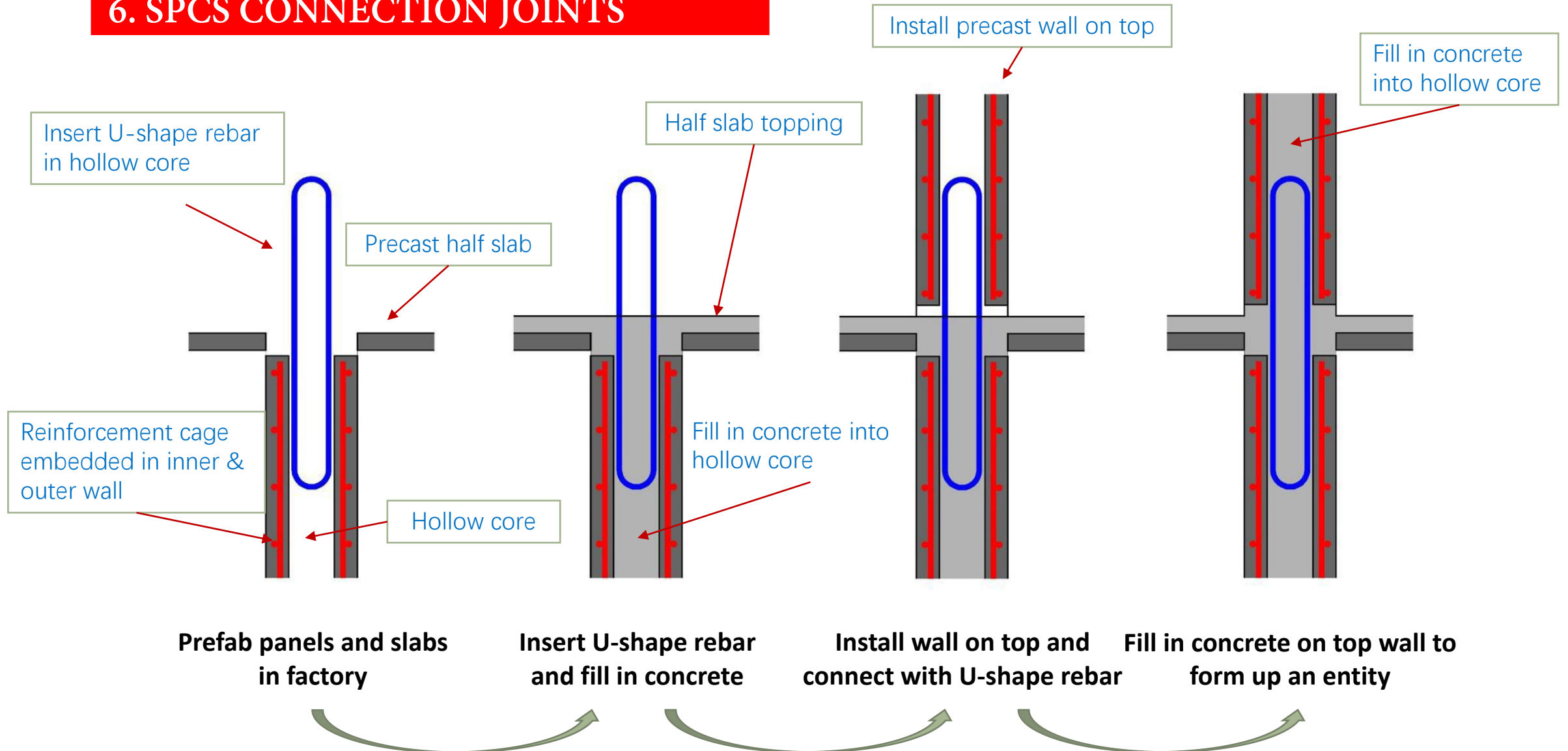

7 ADVANTAGES OF SPCS SYSTEM

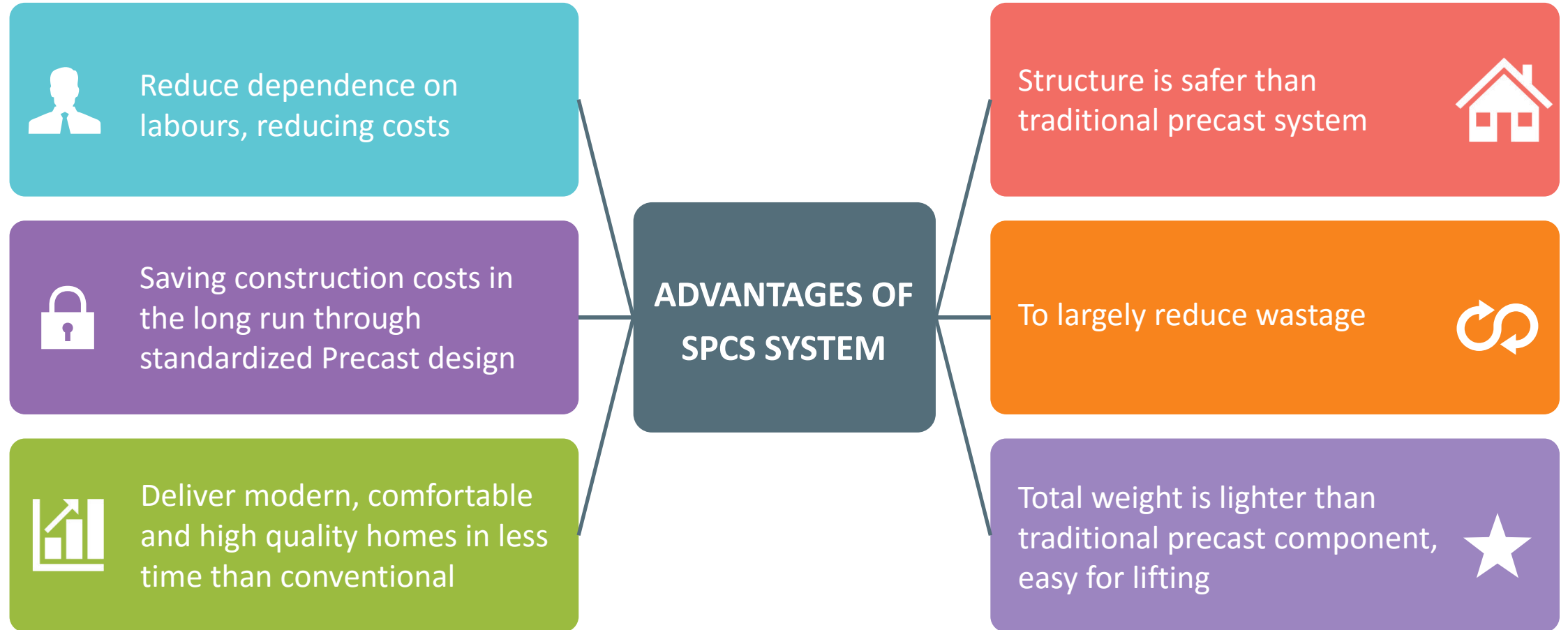

THANK YOU AGAIN FOR YOUR TRUST IN SANY

